

RIVERHOMES

Riverside Quarter
Wandsworth SW18

£520,000
Leasehold



Tucked away within an exclusive riverside enclave, this second floor apartment features a stylish open-plan kitchen and reception space, designed for both relaxing and entertaining. Full-height doors open onto a private west-facing balcony, offering panoramic views of the river. The spacious double bedroom also enjoys direct balcony access, while a modern bathroom completes the interior. Residents benefit from a private gym, indoor swimming pool, and secure underground parking. Nestled in the green expanse of Wandsworth Park and the Thames Path, just a short walk to the boutiques and cafés of Putney High Street and Wandsworth Town.

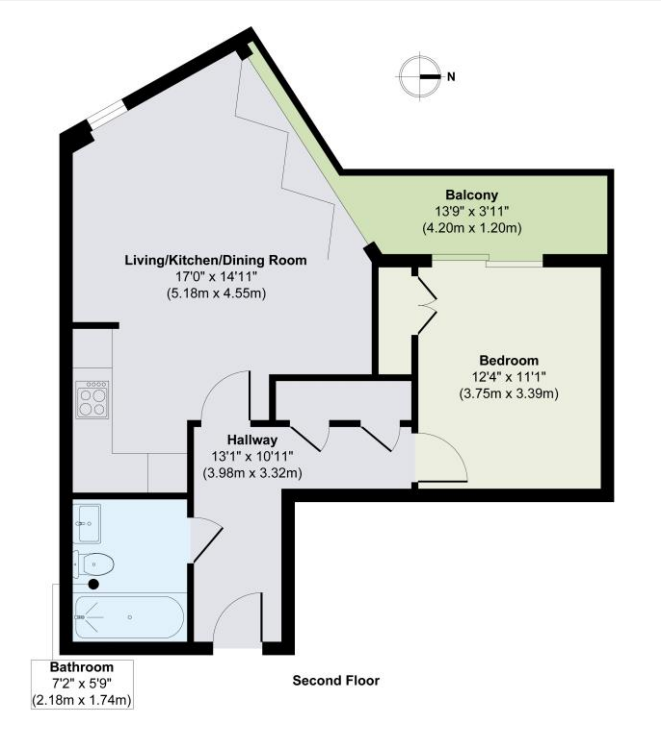

ENERGY PERFORMANCE CERTIFICATE

Score	Energy rating	Current	Potential
92+	A		
81-91	B	83 B	84 B
69-80	C		
55-68	D		
39-54	E		
21-38	F		
1-20	G		

KEY INFORMATION

Local authority:	London Borough of Wandsworth
Internal area:	548 sq. ft. / 51 sq. m
No. of bedrooms:	1
Council tax band:	E
Lease length:	976 years approx. remaining
Ground rent:	£350 per annum approx.
Service charge:	£4,500 per annum approx.